

Indmar Products

5400 Old Millington Rd.
Millington, TN 38053
Phone 901-353-9930
Fax 901-358-4292

SERVICE Procedure

Date: 7/2/2014

Alert: SP2015-2

Subject: 6.2L Indmar/Ford Serpentine Belt Service

NOTICE: Under no circumstances should the accessory drive belt, tensioner or pulleys have any fluids or belt dressing applied to them as damage to the belt material and tensioner damping mechanism may occur.

Materials as Required

Accessory Drive Belt P/N 725901 for 6.2L Naturally Aspirated Engine (400 & 440)

Accessory Drive Belt P/N 725902 for 6.2L Supercharged Engine (575)

Check the belt length indicator on the belt tensioner is in the acceptable belt installation and wear range (See Diagram Below). If the indicator is in the belt replacement range, either an incorrect belt is installed or the belt is worn beyond the service limit. Install a new belt as necessary.

- 1, Belt Length Indicator
2. Acceptable Belt Range
3. Belt Replacement Range
4. Belt Tension Relief Point

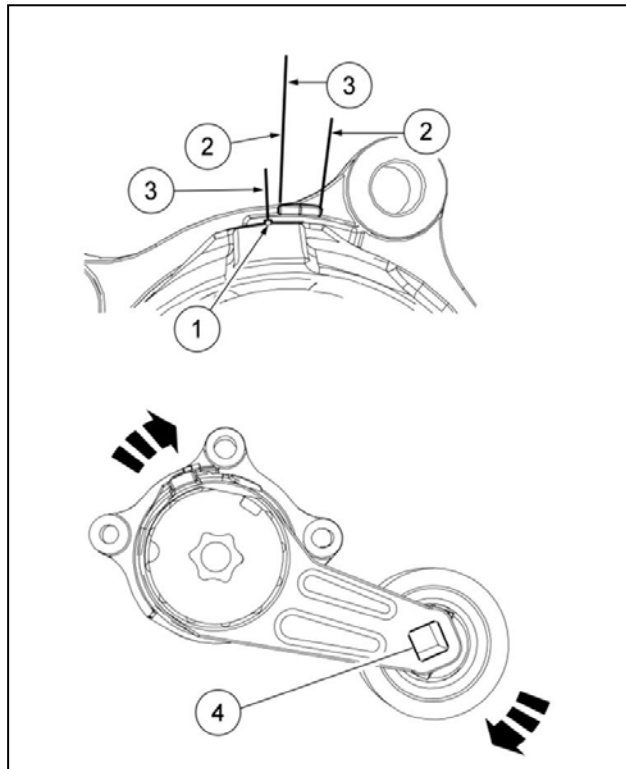

Belt Removal and Installation

NOTE: Depending on the model, you may have to remove the raw water pump, raw water hoses or other brackets to be able to remove the belt.

Release the tension on the belt by installing a ½” drive breaker bar into the belt tension relief point. Remove the belt.

Install the new belt, routing it as shown in the diagram below. Use a ½” drive breaker bar in the belt tension relief point to relieve the tension and complete the installation.

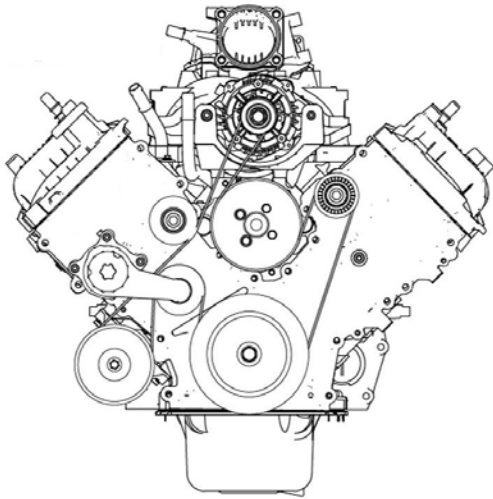

400 & 440 Belt Routing



575 Belt Routing

Serpentine Belt Inspection

1. Check the belt for cracks. Up to 15 cracks in a rib over a distance of 4.0 inches (100 mm) is considered acceptable. If cracks exceed this standard, install a new belt.

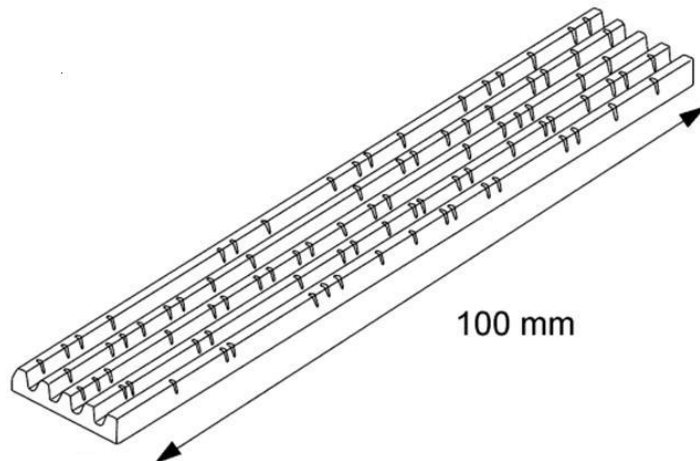

2. Check belt for piling which is an excessive build up in the v-grooves of the belt.

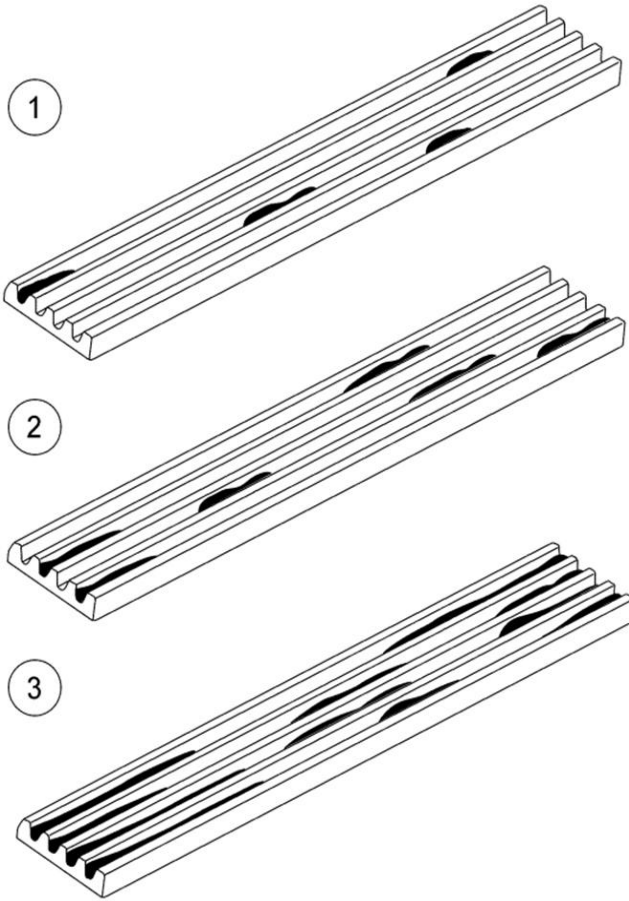

- 1. Small scattered deposits of rubber material – **OK**
- 2. Longer deposits building up to 50% of the rib height – **OK**
- 3. Heavy deposits building up along the grooves – **Replace Belt.**

3. There should be no chunks missing from the belt ribs.

